

1. Pascal Clamp TYB



Dust proof cover + heat proof sealing + grip handle

Model		TYB040	TYB063	TYB100	TYB160	TYB250
Clamping force (at 24.5 MPa)	kN	39.2	61.7	98	156	245
Full stroke	mm	10	10	12	12	12
Clamping stroke	mm	4	4	4	4	4
Safety stroke	mm	6	6	8	8	8
Cylinder capacity (at full stroke)	cm ³	16.5	26.1	47.2	78.2	130
Proof pressure	MPa	36.7				
Max. hydraulic pressure	MPa	24.5				
Operating temperature	°C	5 ~ 120				
Weight	kg	4.5	9	15	25	45

- Safety stroke and clamping stroke shown above are subject to change depending on dimensions of die and T-slot.
- Weight varies according to the dimension of clamp T-leg and die plate thickness h.

2. Pascal Clamp TYB-Z / TYB-R

Automatic slidable type

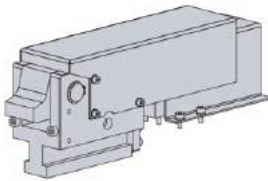

Automatic slidable type with limit switch (Die detection proximity switch)

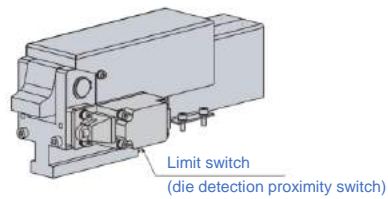

Model		TYB040Z	TYB063Z	TYB100Z	TYB160Z	TYB250Z
		TYB040R	TYB063R	TYB100R	TYB160R	TYB250R
Clamping force (at 24.5 MPa)	kN	39.2	61.7	98.0	156	245
Full stroke	mm	10	10	12	12	12
Clamping stroke	mm	4	4	4	4	4
Safety stroke	mm	6	6	8	8	8
Cylinder capacity (at full stroke)	cm ³	16.5	26.1	47.2	78.2	130
Proof pressure	MPa	36.7				
Max. hydraulic pressure	MPa	24.5				
Standard sliding stroke * 1	mm	50, 75, 100, 125, 150	50, 75, 100, 125, 150, 200	50, 75, 100, 125, 150, 200, 250, 300		
Slider driving speed	MPa	0.39 ~ 0.54				
Clamp sliding speed	mm/s	0.39 ~ 80 (Adjusted by a flow control valve)				
Operating temperature	°C	0 ~ 70 (5~120 by heat proof type * 2)				

- Mass varies according to specifications. Contact Pascal for the details.
- * 1 : Contact Pascal for the sliding stroke which is not mentioned above.
- * 2 : Proximity switch and auto switch is not applied to a heat proof type.